

SECTION II

TM 9-2330-207-24P

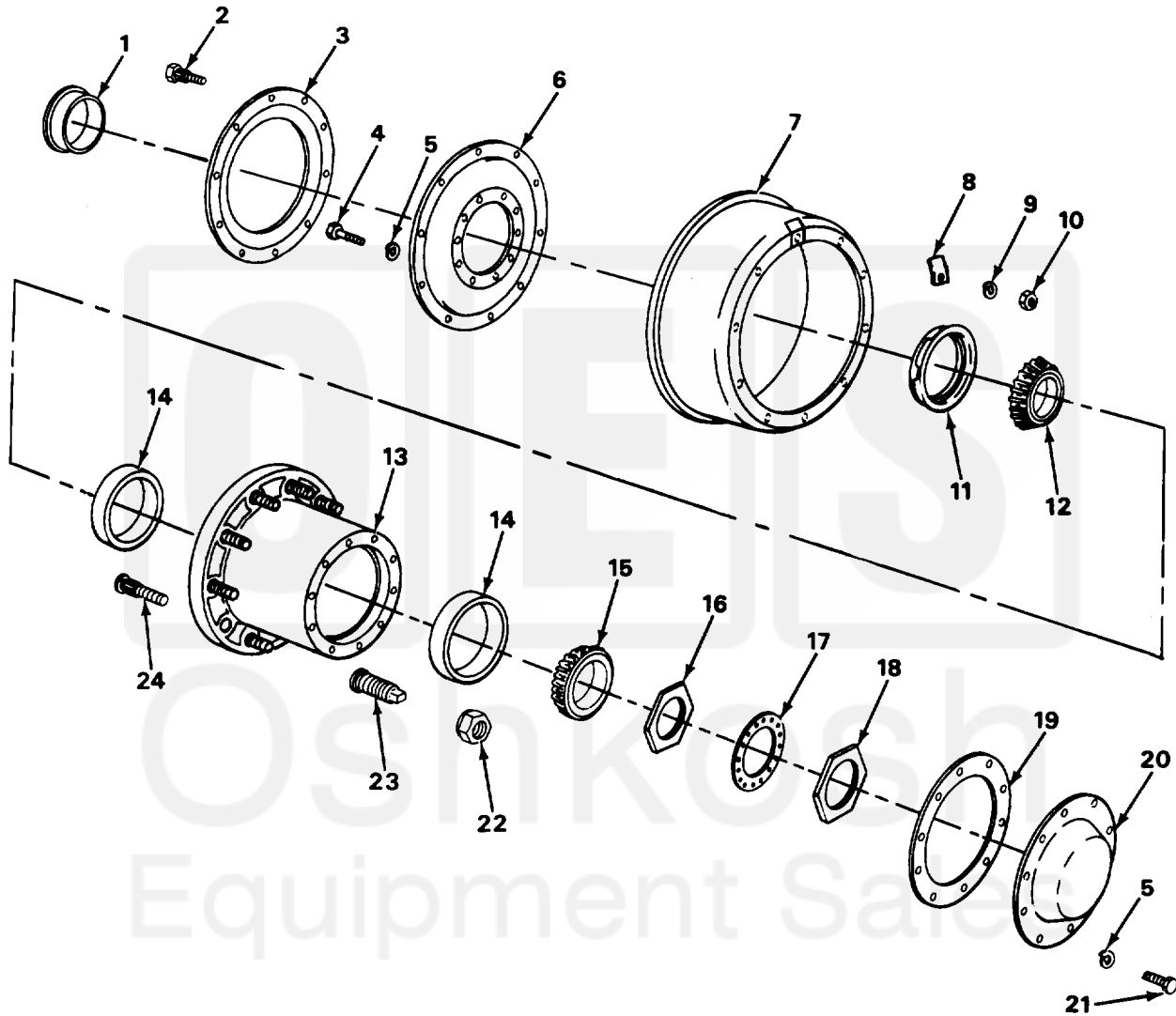

TA706120

FIGURE 38. HUB AND BRAKEDRUM ASSEMBLY (M127).

Current part is item (23,24) on diagram. Available at [www.oshkoshequipment.com](http://www.oshkoshequipment.com)

SECTION II (1)	ITEM (2)	SMR (3)	TM9-2330-207-24P (4)	(5)	(6)
NO	CODE	CAGEC	PART NUMBER	DESCRIPTION AND USABLE ON CODES (UOC)	QTY
22	PAOZZ	96906	MS51983-3	NUT,PLAIN,SINGLE BA LEFT OUTER UOC:260	10
23	PAOZZ	96906	MS53068-1	NUT,CAP,DUAL WHEEL INNER RIGHT UOC:260	10
23	PAOZZ	96906	MS53068-2	NUT,CAP,DUAL WHEEL LEFT, INNER UOC:260	10
24	PAOZZ	96906	MS51946-1	BOLT,RIBBED SHOULDE WHEEL, LH THD UOC:260	10
24	PAOZZ	96906	MS51946-2	BOLT,RIBBED SHOULDE R.H. THD UOC:260,673,674,680	10

END OF FIGURE



Current part is item (23,24) on diagram. Available at [www.oshkoshequipment.com](http://www.oshkoshequipment.com)

SECTION II

TM 9-2330-207-24P

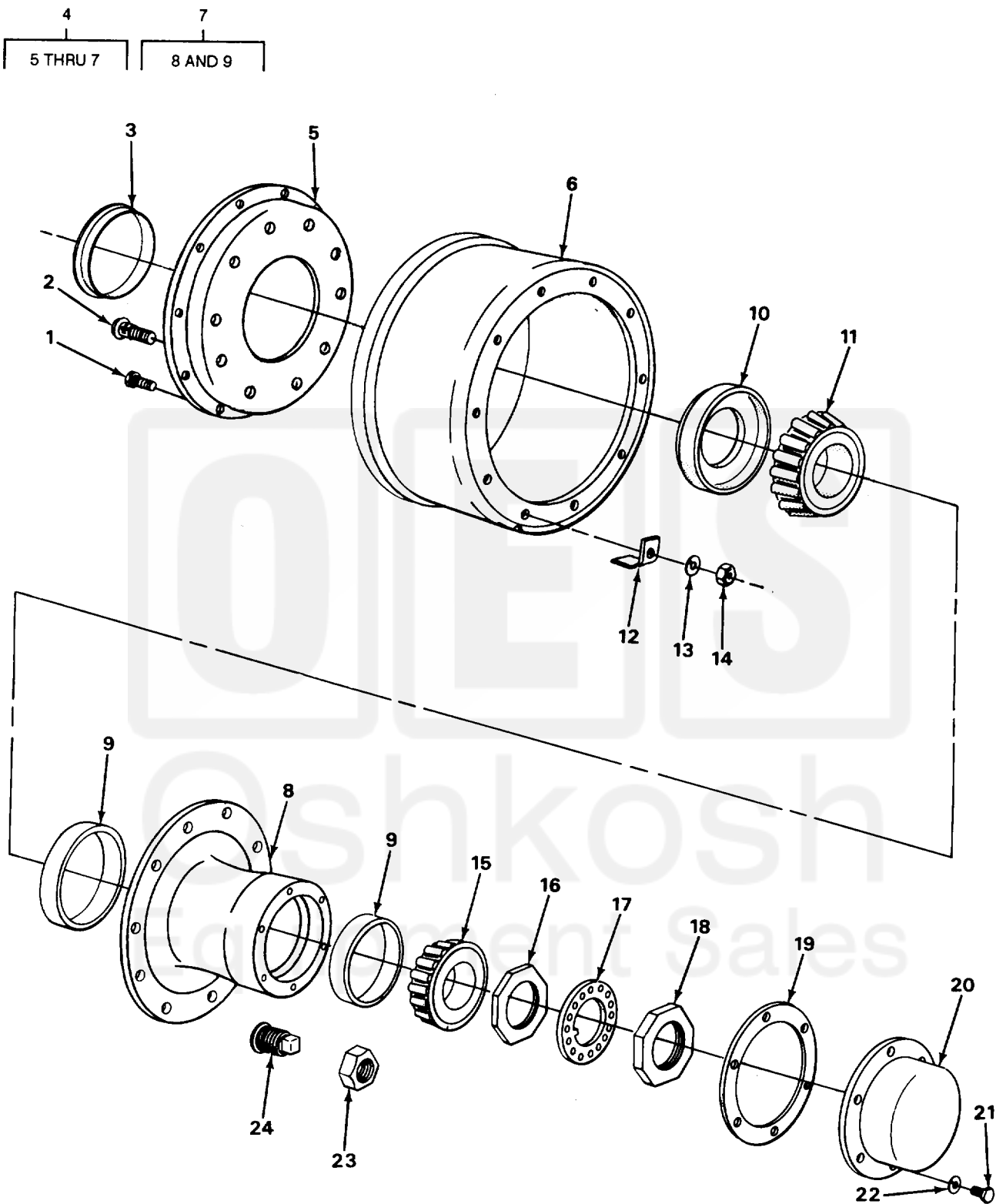

TA706121

FIGURE 39. HUB AND BRAKEDRUM ASSEMBLY (ALL EXCEPT M127).

Current part is item (23,24) on diagram. Available at [www.oshkoshequipment.com](http://www.oshkoshequipment.com)

SECTION (1)	II (2)		TM9-2330-207-24P (4)		(5)	(6)
ITEM NO	SMR CODE	CAGEC	PART NUMBER		DESCRIPTION AND USABLE ON CODES (UOC)	QTY
15	PAOZZ	21450	703077		BEARING,ROLLER,TAPE OUTER UOC:131,133,671,673,674,680,681,682, 684	2
16	PAOZZ	19207	7979308		NUT,PLAIN,OCTAGON UOC:131,133,671,673,674,680,681,682, 684	2
17	PAOZZ	19207	5139123		WASHER,KEY UOC:131,133,671,673,674,680,681,682, 684	2
18	PAOZZ	19207	7979263		NUT,PLAIN,OCTAGON UOC:133,671,673,674,680,681,682	2
19	PAOZZ	19207	8710726		GASKET UOC:131,133,671,673,674,680,681,682, 684	2
20	PAOZZ	19207	8710725		COVER,ACCESS UOC:131,133,671,673,674,680,681,682, 684	2
21	PAOZZ	96906	MS90728-30		BOLT,MACHINE UOC:131,133,671,673,674,680,681,682, 684	12
22	PAOZZ	96906	MS35338-45		WASHER,LOCK UOC:131,133,671,673,674,680,681,682, 684	12
23	PAOZZ	96906	MS51983-3		NUT,PLAIN,SINGLE BA LH THREADS UOC:131,133,671,673,674,680,681,682, 684	10
23	PAOZZ	96906	MS51983-4		NUT,PLAIN,SINGLE BA RH THREADS UOC:131,133,671,673,674,680,681,682, 684	10
24	PAOZZ	96906	MS53068-1		NUT,CAP,DUAL WHEEL L.H. THD UOC:131,133,671,673,674,680,681,682, 684	10
24	PAOZZ	96906	MS53068-2		NUT,CAP,DUAL WHEEL R.H. THD UOC:131,133,671,673,674,680,681,682, 684	10
END OF FIGURE						

Current part is item (23,24) on diagram. Available at [www.oshkoshequipment.com](http://www.oshkoshequipment.com)